

BOX BUTTE COUNTY DAWES COUNTY
 SIOUX COUNTY SHERIDAN COUNTY
 NEBRASKA

Mapa okresů Box Butte, Dawes, Sioux a Sheridan.

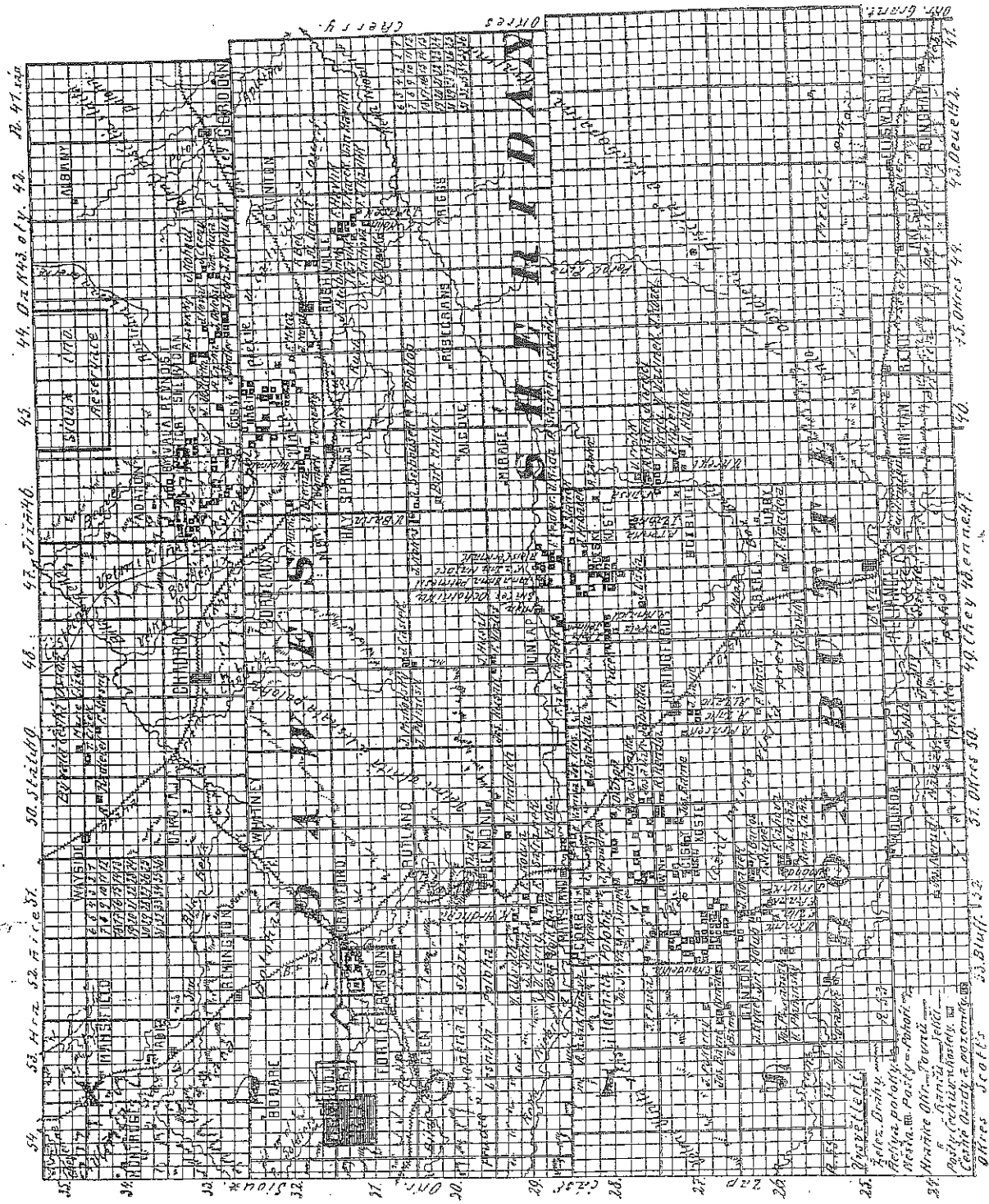

SHERIDAN COUNTY, NEBRASKA

(It) lies in the northwestern part of the state bordering South Dakota. It has 8667 inhabitants. Rushville is the county seat and the government agency for the Pine Ridge Reservation which is found in Dakota. The county is a large one, covering 2466 quarter miles. There is a great difference in the lay of the land and also the crops.

The land in the northwest is mostly rolling and the hills are overgrown with trees. Other parts are moderately rolling and in smaller parts quite level. Other parts are unsettled as they are in the sand hills. Also it is sandy along the Niobrara River and in the valleys of the Rush River. Crops in the moderately rolling land are quite good. Although, you can find places that are salty or gravelly. Water levels are deep, 100 to 150 feet deep. Most shallow waters in the county are found along the valleys of the Box Butte River.

The Czech communities in the county are found in the north and northwest from Rushville and north of Hay Springs where the reservation of Fort Sheridan was located. Here the lay of the land is very rolling (hilly). The settlers are as a whole, do farming in the valleys, at times cut wood for sale. Around here my news of the birthplace of the settlers is very incomplete and in pieces, and to visit each one, is nearly impossible with a great loss of time. And so in many dwellings, their eyes must be closed to the hill traveler or he isn't seen until he rests on the ridge of the hill and then looks in a hurry to the road or where he could have walked from. Then in his sight emerges a live person, just like in a fairytale from a cursed castle. I haven't much taste for the distant deep valleys and hills and across lower elevation, again turning twisting hollows further and further! Smaller distances amount to several miles to walk to a house and not to find half at home, as they are either cutting wood or are in town so the trip is in vain.

Communities farther are toward Hay Springs and Rushville, they are found on land that is moderately gravelly, but the soil is better and productive. The third settlement is found near the Box Butte River that lies near the border of the county of the same name. On the whole, the social life for the countryman is scattered as they live so far apart.

CZECH SETTLERS IN COUNTY

<u>Name and postoffice</u>	<u>A.</u>	<u>S.</u>	<u>T.</u>	<u>R.</u>	<u>Village</u>	<u>Place of Birth</u>	
						<u>Town</u>	<u>County</u>
Box Butte:							
Ant. Hajek	480	5,6) 21)	27	46	Rencov	N. Straseci	Praha
Vac. Hajek	320	17	27	46	Rencov	N. Straseci	Praha
Vac. Vacinek	160	7	27	46	Rencov	N. Straseci	Praha
Jan Kozel	160	8	27	46	Olsany	N. Straseci	Praha
Vaclav Frclik	160	31	28	46	Rencov	N. Straseci	Praha
Josef Krejci	160	6	27	46	Vyskoupek	Zbirov	Praha
Vac. Krejci	320	7,20	27	46	Vyskoupek	Zbirov	Praha
Anna Krejci	80	6	27	46	Vyskoupek	Zbirov	Praha

Czech Settlers - Sheridan County - cont'd
(2)

<u>Name and postoffice</u>	<u>A.</u>	<u>S.</u>	<u>T.</u>	<u>R.</u>	<u>Village</u>	<u>Place of Birth</u> <u>Town</u>	<u>County</u>
Rushville:							
Alois Drimei	160	31	32	43	Babice	Rosice	Brno
Jos. Havlik	400	9,10)	31	43	Rokydno	N. Mesto	Jihlava
		16)					
Fr. Havlik	320	10	31	43	Rokydno	N. Mesto	Jihlava
F.J. Havlik	320	14,15	31	43	Rokydno	N. Mesto	Jihlava
Jan Havlik	160	15	31	43	Rokydno	N. Mesto	Jihlava
Fr. Marek	160	15	31	43	Brezany	Horazdovice	Plzen
Fr. Machova (lady) (Mach)	120	16	31	43	V. Lohovice	Zbirov	Praha
Vac. Kolin	160	22	31	43	Techonice	Flanice	Plzen
Vacl. Denk	160	28	31	43	Poborovice	Klatovy	Plzen
Jos. Masek	160	23	31	43	N. Dvory	Selcany	Tabor
Jos. Kuca	160	29	33	43	Svetrov	Pribyslav	Caslav
Jan Cerny	160	21	33	43	Sykorice	Krivoklat	Praha
Josef Kohout	320	20,29	33	43	Radostin	Pribyslav	Caslav
Vaclav Jindra	160	2,3	32	45	Hvozď	Kralovice	Plzen
Jos. Hrabanek	160	3	32	45	Podveky	Kut. Hora	Caslav
	160	8	31	45			
Josef Novotny	160	3	32	45	Kukle	Vodnany	Pisek
Fer. L. Novotny	160	3	32	45	Kukle	Vodnany	Pisek
	160	27	33	45			
Fr. Skoda	320	9,16	32	45	Presovice	Krumlov	Znojmo
Jan Soper	160	10	32	45	Krastavice	Kralovice	Plzen
Fr. Bazil	160	15	32	45	Ouboc	N. Kdyne	Plzen
Fr. Bartu	160	16	32	45	Strmelov	Jind. Hradiste	
Pavel Kouba	240	16,21	32	45	Radlice	Dacice	Jihlava
Fr. Stava	480	21,22	32	45	Hrotovice		Znojmo
Fr. Habart	160	22	32	45	Vlastec		Pisek
Fr. Maca	320	13,24	32	45	Slavikovice	Trebic	Jihlava
Tom. Kadlik	160	27	32	45	Slavikovice	Klatovy	Plzen
Jan J. Novotny	160	31	32	44	Do not know		
Fr. Lavicky	320	17	32	44	Hostalkov	Trebic	Jihlava
Jos. Vodicka	320	20	33	44	Chlumetin	Hlinsko	Chrudim
Jos. Novak	160	22	33	44	Do not know		
Jan Krotz	320	35	33	44	Sv. Kriz	Rokycany	Plzen
Ant. Cacka	160	28	33	44	Kridla	N. Mesto	Jihlava
Jos. Cacka	160	28	33	44	Kridla	N. Mesto	Jihlava
Jan Dolezal	160	27	33	44	Blazkov	N. Mesto	Jihlava
Jan Sindler	160	34	33	44	Sykorice	Krivoklat	Praha
Hay Spring:							
Vac. Kuba	160	20	33	46	Zahradka	Telc	Jihlava
Josef Fritec	160	21	33	46	Do not know		
Mart. Cilek	160	21,28	33	46	Sobeslav	Veseli	Tabor
Vac. Benes	160	25	33	46	Kam. Mosty	Habry	Caslav
Jos. Marecek	160	25	33	46	Rimovice	Habry	Caslav
Ant. Kadlecek	280	26,27	33	46	Cernejs	Vlasim	Tabor
	160	11,36	34	50	Dawes County, Nebraska		
	160	34	33	46	Do not know		
Jos. Bittner	160	17	33	45	Uhersky, Slovan		
Emil Knezovic	160	17	33	45	Novosedla	Lomnice	Budejovice
Jos. Vocu	160	17	33	45	Roudny	Sobeslav	Tabor
Jos. Jirek	160	18	33	45			

Czech settlers - Sheridan County - cont'd
(3)

Name and postoffice	A.	S.	T.	R.	Village	Place of Birth		
						Town	County	
Hay Spring:								
Kat. Hodinar	160	18	33	45	Roudny	Sobeslav	Tabor	
Fr. Kubat	160	19	33	45	Hadina	Humpolec	Caslav	
Mat. Kocian	160	31	33	45	Duskov	Prestice	Plzen	
Rom. Svoboda	160	6	32	45	Lisov	Trebon	Budejovice	
Vac. Pisacka	320	7	32	45	Hosti	Vl. Tyn	Pisek	
Vacl. Prokop	160	5	30	45	Brusice	Cer.	Kostelec	
Bart. Mayer	160	18	30	46	Prestice	Prestice	Plzen	
Vac. Novak	160	27, 34	33	46	Voralna	Podebrady	Caslav	
Ant. Serbousek	160	6	30	46	Javornice	Rychnov		
Vac. Kitzberger	160	1	32	46	Near Domazlic,	Plzen		
Cenek Kruml	160	13	32	46	Do not know			
Fr. Pliska	160	19	32	46	Do not know			
Tom. Jirovsky	160	26	32	46	Petrovice	Trebic	Jihlava	
Fr. Vomocil	Rent	26	32	46	Osik	Litomysle	Chrudim	
Kat. Syrový	Exch	26	32	46	Doubravice	Vys. Myto		
Jos. Vybiral	160	27	32	46	Petrovice	Trebic	Jihlava	
Vac. Dremza	160	27	32	46	Vyskydna	Pelhrimov		
Adaton:								
Fr. Paul	160	2	33	46	Do not know			
Jan Paul	160	3	33	46	Do not know			
Jos. Paul	160	3	33	46	Do not know			
Ad. Paul	160	9	33	46	Do not know			
Jos. Hastera	160	5	33	46	Do not know			
Jos. Rysavy	160	7	33	46	Hnevkovice	D. Kralovice		
Fr. Studihrad	160	7, 18	33	46	Hosti	Vl. Tyn	Pisek	
Jak. Bumba	160	7, 8	33	46	Cihalin	Trebic	Jihlava	
Jos. Bumba	160	8	33	46	Cihalin	Trebic	Jihlava	
Ant. Stepanek	160	8, 9	33	46	Do not know			
Fr. Novak	480	27, 9, 28	33	46	Voralna	Podebrady	Caslav	
Marie Svoman	160	10, 15	33	46	Do not know			
Mat. Kuba	160	17	33	46	Zahradka	Telc	Jihlava	
Bart. Kuba	160	17	33	46	Zahradka	Telc	Jihlava	
Jos. Baltizar	160	18	33	46	Do not know			
Fr. Cilek	160	18	33	46	Sobeslav	Veseli	Tabor	

Lives in Town

Hay Spring:								
Jan Horak - In Business	--	--	--	--	Ranna	Litomysle		
J. Horakova (lady) - In retirement (Horak)					Ranna	Litomysle		
P. Serbousek - In business	160	8	32	45	Javornice	Rychnov		
J. Kadlecek - Innkeeper	160	12	32	46	Cernejs	Vlasim	Tabor	
Rushville:								
Jan Rocek - Innkeeper					Pol. Mantice	Kourim		
Fr. Rocek - Innkeeper					Pol. Mantice	Kourim		

	Owns Land Here	but Lives	Elsewhere	
Fr. Stanek	80	16	32	45 Dunlap, Dawes County, Nebraska
J. Tobias	160	23	32	45 Omaha, Nebraska
Fr. Bel	160	31	32	43 Omaha, Nebraska